

TERMINALS SPECIFICATION DRAWING

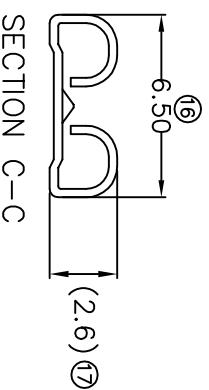
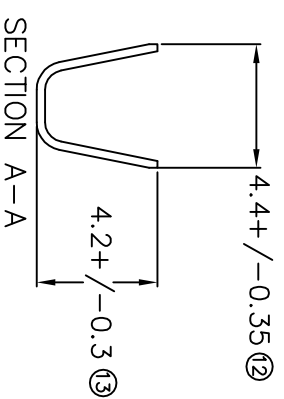
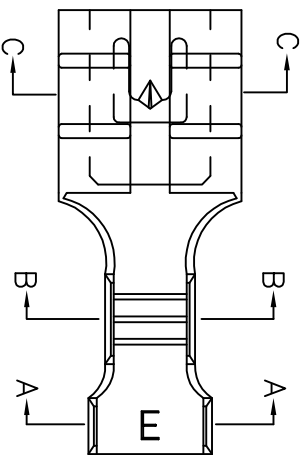
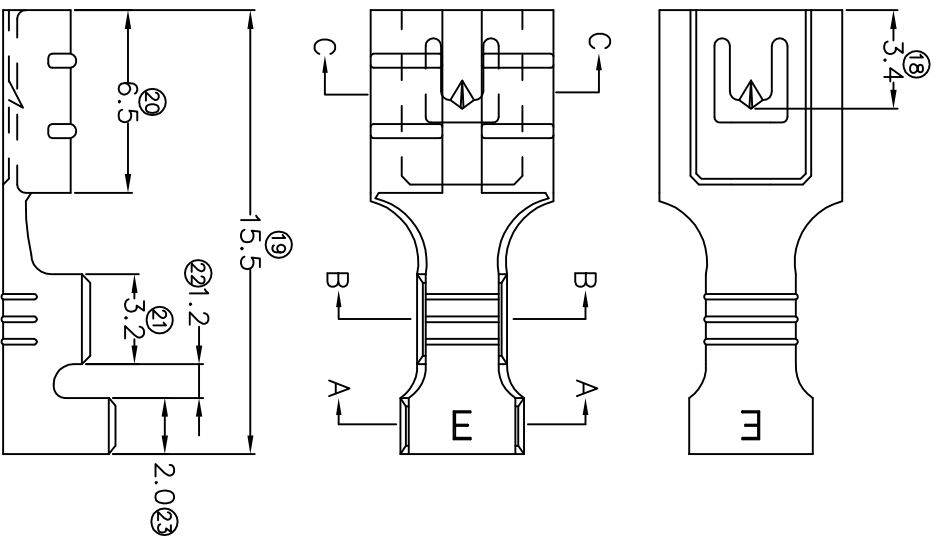

FOR REFERENCE ONLY

- 11) CRIMPING WIRE TENSILE FORCE IS BASE ON COPPER BREAK OFF INTENSITY.
- 10) TEMPERATURE RANGE -40°C TO +120°C.
- 9) VOLTAGE-MAX [VOLTS] PER WIRE SPECIFICATION.
- 8) $\text{\textcircled{1}}$ FOR REFERENCE ONLY.
- 7) MATCHING WITH TAB t0.5 X W5.2.
- 6) TENSILE FORCE : MIN 5.00KG.
- 5) INSERT FORCE : MAX 1.80KG.
- 4) THICKNESS PLATING MORE THAN 40 μ INCH.
- 3) PACKING QTY : 8000 PCS/REEL.
- 2) WIRE INSULATION (O.D) : 2.6MM.
- 1) APPLICABLE WIRE RANGE : 0.91-0.41MM².

SPECIFICATION :

<p>MATERIAL: t0.30 BRASS C2680</p> <p>DIMENSIONS : MM</p> <p>TOLERANCE UNLESS OTHERWISE SPECIFIED:</p> <table style="width: 100%; border-collapse: collapse;"> <tr> <td style="width: 10%;">X.XXX</td> <td style="width: 10%;">+/-0.05</td> </tr> <tr> <td>X.XX</td> <td>+/-0.10</td> </tr> <tr> <td>X.X</td> <td>+/-0.20</td> </tr> <tr> <td>X</td> <td>+/-0.50</td> </tr> </table> <p>EFFECTIVE DATE : 24/7/07</p>	X.XXX	+/-0.05	X.XX	+/-0.10	X.X	+/-0.20	X	+/-0.50	<p>TIN PLATING</p> <p>NONE</p> <p>TREATMENT SELECTIVE</p>	<p>17205MA-2</p> <p>17205MA-1</p> <p>PART NUMBER</p>
X.XXX	+/-0.05									
X.XX	+/-0.10									
X.X	+/-0.20									
X	+/-0.50									
<p>REVISION: 03</p> <p></p>	<p>CHK: SC CHOO</p> <p>Y.L</p> <p>APVD: CHUANG</p> <p>SCALE : FREE</p> <p>DRAWING NO: A1279</p>	<p>PART NAME: 205 SERIES FEMALE TERMINALS</p> <p>APPLICABLE (1) TERMINALS (2) HOUSING</p> <p>(1) TAB t0.5 X W5.2 (2) -</p>								
<p>SHEET OF : 1 / 1</p>	<p>EPI Terminals & Connectors Elamp Precision Industry(M) Sdn.Bhd.</p>									